



108A New Haw Road, Addlestone, KT15 2DF

£1,100 Per Calendar Month



# 108A New Haw Road, Addlestone, KT15 2DF

One Bedroom First Floor Apartment – Excellent Location in Addlestone

A well-presented one-bedroom first-floor apartment ideally situated within easy walking distance of the Addlestone One development, offering a wide selection of shops, restaurants, cinema, and leisure facilities.

Addlestone Station and local transport links are also just a short walk away, making the property particularly suitable for commuters. A variety of everyday amenities are close by, providing convenience for day-to-day living.

The accommodation comprises a bright open-plan kitchen/living room, a good-sized double bedroom, and a modern bathroom suite.

Further benefits include gas central heating and an allocated parking space.

Available to let, this property offers modern, low-maintenance living in a highly convenient location. Early viewing is recommended.



Floor Plan

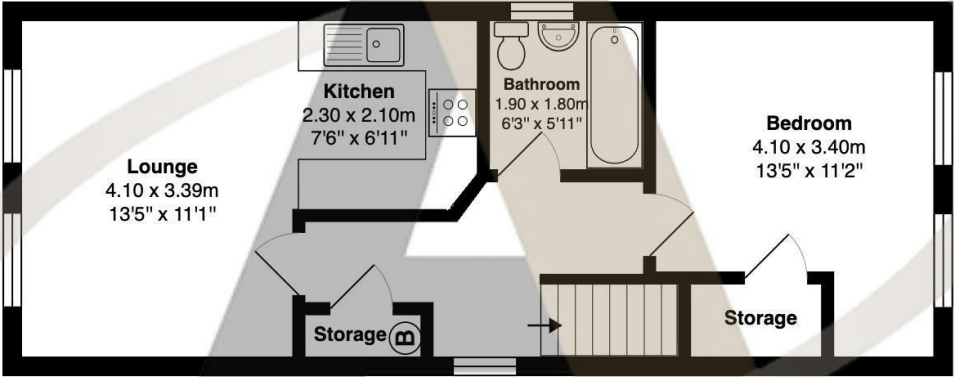

First Floor

New Haw Road, Addlestone, KT15 2DF

Total Area: 45.7 m<sup>2</sup> ... 492 ft<sup>2</sup>

All measurements are approximate and for display purposes only



Features

- One bedroom first floor apartment
- Modern bathroom suite
- Allocated parking space
- Open plan kitchen / living room
- Gas central heating
- Short walk to Addlestone One, station and local amenities

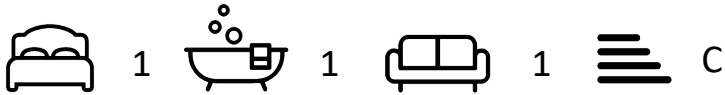

Tenure - Council Tax Band - C



